

3.7 TCP

Self-tapping screw with extra-flat head



Steel



Available in stainless

Coatings



Zinc-plated coating



White zinc-plated



Black zinc-plated



Ph #2

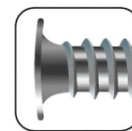

Extra-flat head



Self-tapping Point C

Properties

Code

ST 4.2

d_k : head diameter	[mm]	8.0
k: head thickness	[mm]	0.5
Ph bit no.		2
D: exterior thread diameter	[mm]	4.22
d: interior thread diameter	[mm]	3.10
p: thread	[mm]	1.4
y: point length \leq	[mm]	13 – 32
Countersunk head angle	φ	65
Installation bit code (Ph)		PUPHC02 PUPHL02

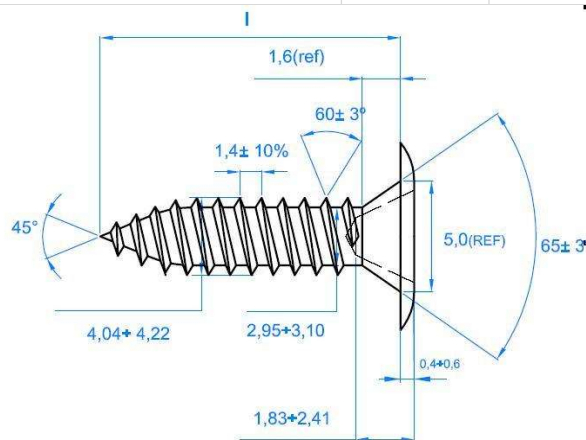
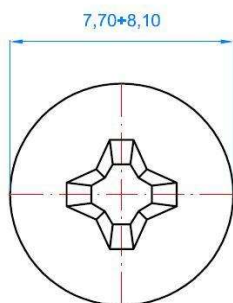

- Zinc-plated (code TCPZ), black zinc-plated (code TCPN), or completely white RAL 9010 painted (code TCPB) finishes.
- Version in A2 stainless steel, AISI 304 (code TCPA2).
- Bevelled head to prevent snagging on sliding parts.
- For joints on metal which require a very low head (sliding doors and windows, inlaid locks, etc.).
- May be used as a substitute for rivets in many applications, with the advantage of being removable.
- Reduced cone under head to improve finish on flat surfaces.
- For aluminium fixings, use stainless steel screw.